



UT Spot Track Ø86 GA All White

09.7756.30A78 - White

Spotlight to be installed on 3-phase track with LED light source. 220-240V, 50-60Hz power supply integrated. In the "All white" versions, the track adapter, the arm, the rear of the head and the head are white. Only the anti-glare ring is black.

Main specifications

| | | | |
|-----------------|-------|----------------|--------|
| Number of heads | 1 | Net lumen (lm) | 2190 |
| Lamp category | LED | Mountings | Track |
| Power (W) | 33W | Environment | Indoor |
| CCT (K) | 3000K | | |
| CRI | 90 | | |

Optical

| | |
|------------------------|-----------|
| Lighting type | Direct |
| LED type | LED array |
| Light distribution | Symmetric |
| Optical type | Spot |
| Beam angle (°) | 12 |
| Beam angle C90-270 (°) | 12 |

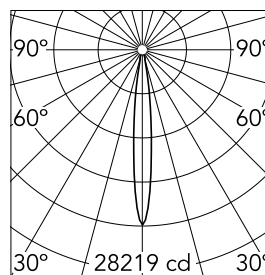

Beam Angle: 12°

h(m) E(lx) D(m)

1 28219 0.21

2 7055 0.41

3 3135 0.62

4 1764 0.82

5 1129 1.03

Luminous flux luminaire
2190 lm

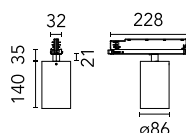

Electrical

| | | | |
|----------------|------------|------------------|----|
| Frequency (Hz) | 50/60 | Insulation class | II |
| Dimmable | No | | |
| Driver | Integrated | | |
| Driver type | Electronic | | |
| Emergency | Without | | |

Physical

| | | | |
|--------------|------------|--------------------|----|
| Color | White | Spot diameter (mm) | 86 |
| Orientation | Adjustable | | |
| Weight (kg) | 0.75 | | |
| Tilt (°) | 90 | | |
| Rotation (°) | 360 | | |

Certification / Marking

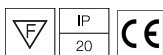

Note

Screening crosspiece, lenses and Honeycomb directly installable on the head of the luminaire without needing any fastening accessory. Installation compatible with Honeycomb + Lense at the same time. FLOS three-phase lighting track luminaires are designed and fully tested for tracks recommended by FLOS. Compatibility is guaranteed with three-phase track produced by Nordic Aluminium. Compatibility with Eutrac under request.

UT Spot Track Ø86 GA All White



Holding ring
08.8410.00



Screening crosspiece
08.8411.00



Elliptical lens
08.8163.68



Flood lens
08.8175.68



Honeycomb
08.8495.14