



## UT Spot Track Ø86 GA All White

09.7733.30.78 - White

Spotlight to be installed on 3-phase track with LED light source. 220-240V, 50-60Hz power supply integrated. In the "All white" versions, the track adapter, the arm, the rear of the head and the head are white. Only the anti-glare ring is black.

### Main specifications

Number of heads	1	Net lumen (lm)	1648
Lamp category	LED	Mountings	Track
Power (W)	26.5W	Environment	Indoor
CCT (K)	3000K		
CRI	98		

### Optical

Lighting type	Direct
LED type	Phosphor LED
Light distribution	Symmetric
Optical type	Spot
Beam angle (°)	16
Beam angle C90-270 (°)	16

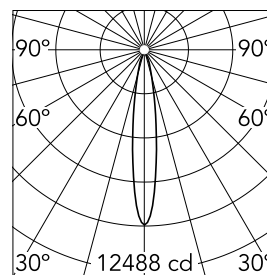

Beam Angle: 16°

h(m) E(lx) D(m)

1 12488 0.28

2 3122 0.55

3 1388 0.83

4 781 1.10

5 500 1.38

Luminous flux luminaire  
1648 lm

### Electrical

Frequency (Hz)	50/60	Insulation class	II
Dimmable	No		
Driver	Integrated		
Driver type	Electronic		
Emergency	Without		

### Physical

Color	White	Spot diameter (mm)	86
Orientation	Adjustable		
Weight (kg)	0.75		
Tilt (°)	90		
Rotation (°)	360		

### Note

Screening crosspiece, lenses and Honeycomb directly installable on the head of the luminaire without needing any fastening accessory. Installation compatible with Honeycomb + Lense at the same time. FLOS three-phase lighting track luminaires are designed and fully tested for tracks recommended by FLOS. Compatibility is guaranteed with three-phase track produced by Nordic Aluminium. Compatibility with Eutrac under request.

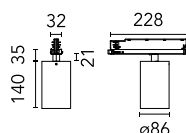

### Certification / Marking

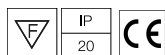

UT Spot Track Ø86 GA All White



---

Holding ring  
08.8410.00

---

Screening crosspiece  
08.8411.00