



UT Spot Track Ø86 GA

09.7754.30A - White

Spotlight to be installed on 3-phase track with LED light source. 220-240V, 50-60Hz power supply integrated. .30 versions come with the track adapter, the arm and the rear of the head in black.

Main specifications

| | | | |
|-----------------|-------|----------------|--------|
| Number of heads | 1 | Net lumen (lm) | 2408 |
| Lamp category | LED | Mountings | Track |
| Power (W) | 33W | Environment | Indoor |
| CCT (K) | 3000K | | |
| CRI | 80 | | |

Optical

| | |
|------------------------|-----------|
| Lighting type | Direct |
| LED type | LED array |
| Light distribution | Symmetric |
| Optical type | Flood |
| Beam angle (°) | 37 |
| Beam angle C90-270 (°) | 37 |

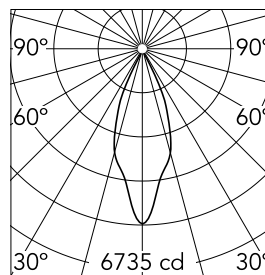

Beam Angle: 37°

| | h(m) | E(lx) | D(m) |
|---|------|-------|------|
| 1 | 6735 | 0.67 | |
| 2 | 1684 | 1.34 | |
| 3 | 748 | 2.01 | |
| 4 | 421 | 2.69 | |
| 5 | 269 | 3.36 | |

Luminous flux luminaire
2408 lm

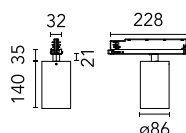

Electrical

| | | | |
|----------------|------------|------------------|----|
| Frequency (Hz) | 50/60 | Insulation class | II |
| Dimmable | No | | |
| Driver | Integrated | | |
| Driver type | Electronic | | |
| Emergency | Without | | |

Physical

| | | | |
|--------------|------------|--------------------|----|
| Color | White | Spot diameter (mm) | 86 |
| Orientation | Adjustable | | |
| Weight (kg) | 0.75 | | |
| Tilt (°) | 90 | | |
| Rotation (°) | 360 | | |

Certification / Marking

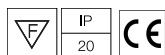

Note

Screening crosspiece, lenses and Honeycomb directly installable on the head of the luminaire without needing any fastening accessory. Installation compatible with Honeycomb + Lense at the same time. FLOS three-phase lighting track luminaires are designed and fully tested for tracks recommended by FLOS. Compatibility is guaranteed with three-phase track produced by Nordic Aluminium. Compatibility with Eutrac under request.

UT Spot Track Ø86 GA



Holding ring
08.8410.00



Screening crosspiece
08.8411.00



Elliptical lens
08.8163.68



Flood lens
08.8175.68



Honeycomb
08.8495.14