



## UT Spot Track Ø86 GA

■ 09.7752.14A - Black

Spotlight to be installed on 3-phase track with LED light source. 220-240V, 50-60Hz power supply integrated.

### Main specifications

Number of heads	1	Net lumen (lm)	2528
Lamp category	LED	Mountings	Track
Power (W)	33W	Environment	Indoor
CCT (K)	3000K		
CRI	80		

### Optical

Lighting type	Direct
LED type	LED array
Light distribution	Symmetric
Optical type	Medium
Beam angle (°)	24
Beam angle C90-270 (°)	24

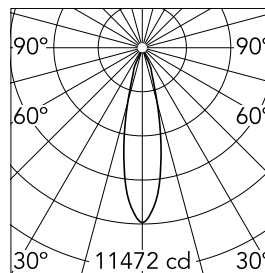

Beam Angle: 24°

h(m)	E(lx)	D(m)
1	11472	0.43
2	2868	0.86
3	1275	1.28
4	717	1.71
5	459	2.14

Luminous flux luminaire  
2528 lm

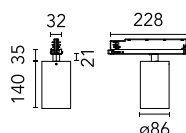

### Electrical

Frequency (Hz)	50/60	Insulation class	II
Dimmable	No		
Driver	Integrated		
Driver type	Electronic		
Emergency	Without		

### Physical

Color	Black	Spot diameter (mm)	86
Orientation	Adjustable		
Weight (kg)	0.75		
Tilt (°)	90		
Rotation (°)	360		

### Certification / Marking

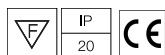

### Note

Screening crosspiece, lenses and Honeycomb directly installable on the head of the luminaire without needing any fastening accessory. Installation compatible with Honeycomb + Lense at the same time. FLOS three-phase lighting track luminaires are designed and fully tested for tracks recommended by FLOS. Compatibility is guaranteed with three-phase track produced by Nordic Aluminium. Compatibility with Eutrac under request.

UT Spot Track Ø86 GA



---

Holding ring  
08.8410.00



---

Screening crosspiece  
08.8411.00



---

Elliptical lens  
08.8163.68



---

Flood lens  
08.8175.68



---

Honeycomb  
08.8495.14