



## UT Spot Track Ø 86 GA

■ 09.7750.30A - White

Spotlight to be installed on 3-phase track with LED light source. 220-240V, 50-60Hz power supply integrated. .30 versions come with the track adapter, the arm and the rear of the head in black.

### Main specifications

Number of heads	1	CRI	80
Lamp category	LED	Net lumen (lm)	2650
Power (W)	33W	Mountings	Track
System power (W)	33	Environment	Indoor dry location
CCT (K)	3000K		

### Optical

Lighting type	Direct
LED type	LED array
Light distribution	Symmetric
Optical type	Spot
Beam angle (°)	12
Beam angle C90-270 (°)	12

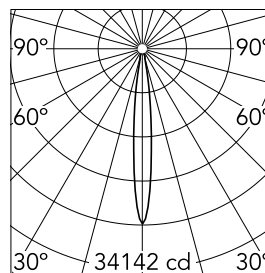

Beam Angle: 12°

h(m) E(lx) D(m)

1	34142	0.21
2	8535	0.41
3	3794	0.62
4	2134	0.82
5	1366	1.03

Luminous flux luminaire  
2650 lm



### Electrical

Frequency (Hz)	50/60	Driver type	Non Dimmable
Voltage (V)	220-240V	Emergency	Without
Current (mA)	900	Insulation class	II
Dimmable	No		
Driver	Integrated		

### Physical

Color	White	Spot diameter (mm)	86
Orientation	Adjustable		
Weight (kg)	0.75		
Tilt (°)	90		
Rotation (°)	360		

### Note

Screening crosspiece, lenses and Honeycomb directly installable on the head of the luminaire without needing any fastening accessory. Installation compatible with Honeycomb + Lense at the same time. FLOS three-phase lighting track luminaires are designed and fully tested for tracks recommended by FLOS. Compatibility is guaranteed with three-phase track produced by Nordic Aluminium. Compatibility with Eutrac under request.

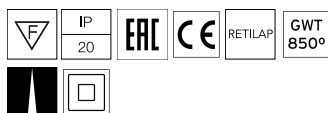
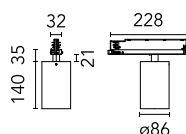

UT Spot Track Ø 86 GA



---

Elliptical lens  
08.8163.68

---

Honeycomb  
08.8495.14

---

Screening crosspiece  
08.8411.00



---

Holding ring  
08.8410.00

---

Flood lens  
08.8175.68