



UT Spot Track Ø 57 GA Dali Version

■ 09.7706.14ADA - Black

Spotlight to be installed on 3-phase track with LED light source. 220-240V, 50-60Hz power supply integrated.

Main specifications

Number of heads	1	Net lumen (lm)	997
Lamp category	LED	Mountings	Track
Power (W)	23.5W	Environment	Indoor dry location
CCT (K)	3000K		
CRI	90		

Optical

Lighting type	Direct
LED type	LED array
Light distribution	Symmetric
Optical type	Spot
Beam angle (°)	10
Beam angle C90-270 (°)	10

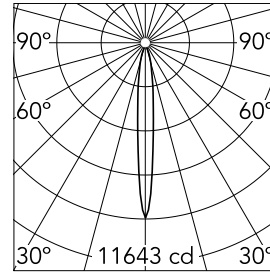

Beam Angle:	10°		
	h(m)	E(lx)	D(m)
1	11643	0.18	
2	2911	0.36	
3	1294	0.54	
4	728	0.72	
5	466	0.90	

Luminous flux luminaire
997 lm

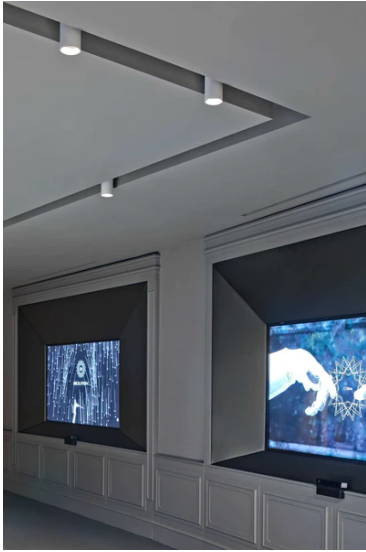

Electrical

Frequency (Hz)	50/60	Insulation class	II
Dimmable	Yes		
Driver	Integrated		
Driver type	Dimmable DALI		
	1		
Emergency	Without		

Physical

Color	Black	Spot diameter (mm)	57
Orientation	Adjustable		
Weight (kg)	0.57		
Tilt (°)	90		
Rotation (°)	360		

Note

Screening crosspiece, lenses and Honeycomb directly installable on the head of the luminaire without needing any fastening accessory. FLOS three-phase lighting track luminaires are designed and fully tested for tracks recommended by FLOS. Compatibility is guaranteed with three-phase track produced by Nordic Aluminium. Compatibility with Eutrac under request. FLOS three-phase DALI track luminaires are designed for Pulse DALI from Nordic Aluminium.

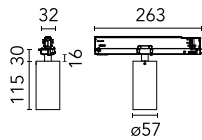

UT Spot Track Ø 57 GA Dali Version



Screening crosspiece
08.8429.00



Flood lens
08.8432.00



Snoot shielding cone
08.0526.40



Snoot shielding cone
08.0526.BW

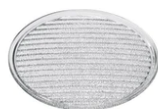

Elliptical lens
08.8431.00



Snoot shielding cone
08.0526.00



Honeycomb
08.8428.00