



## UT Spot Track Ø 57 GA Dali Version

■ 09.7701.14ADA - Black

Spotlight to be installed on 3-phase track with LED light source. 220-240V, 50-60Hz power supply integrated.

### Main specifications

Number of heads	1	Net lumen (lm)	1094
Lamp category	LED	Mountings	Track
Power (W)	23.5W	Environment	Indoor dry location
CCT (K)	4000K		
CRI	90		

### Optical

Lighting type	Direct
LED type	LED array
Light distribution	Symmetric
Optical type	Spot
Beam angle (°)	10
Beam angle C90-270 (°)	10

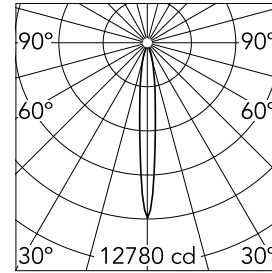

Beam Angle:	10°		
	h(m)	E(lx)	D(m)
1	12780	0.18	
2	3195	0.36	
3	1420	0.54	
4	799	0.72	
5	511	0.90	

Luminous flux luminaire  
1094 lm

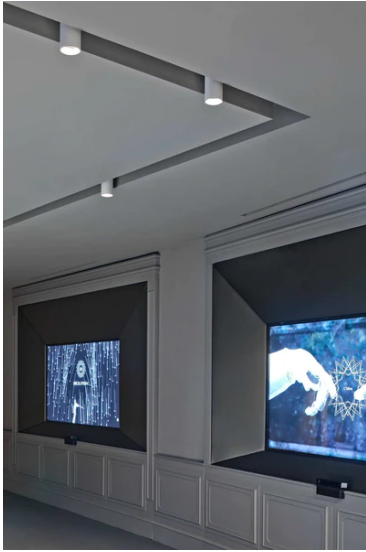

### Electrical

Frequency (Hz)	50/60	Insulation class	II
Dimmable	Yes		
Driver	Integrated		
Driver type	Dimmable DALI		
	1		
Emergency	Without		

### Physical

Color	Black	Spot diameter (mm)	57
Orientation	Adjustable		
Weight (kg)	0.57		
Tilt (°)	90		
Rotation (°)	360		

### Note

Screening crosspiece, lenses and Honeycomb directly installable on the head of the luminaire without needing any fastening accessory. FLOS three-phase lighting track luminaires are designed and fully tested for tracks recommended by FLOS. Compatibility is guaranteed with three-phase track produced by Nordic Aluminium. Compatibility with Eutrac under request. FLOS three-phase DALI track luminaires are designed for Pulse DALI from Nordic Aluminium.

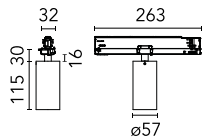

## UT Spot Track Ø 57 GA Dali Version



---

Snoot shielding cone  
08.0526.40



---

Snoot shielding cone  
08.0526.BW



---

Flood lens  
08.8432.00



---

Screening crosspiece  
08.8429.00



---

Snoot shielding cone  
08.0526.00



---

Honeycomb  
08.8428.00

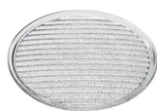

---

Elliptical lens  
08.8431.00