



UT Pro 175 GA-69 On Board Dimmer

■ 09.7318.40 - White

Spotlight to be installed in standard 3-phase track with LED light source. 120-270V power supply integrated. High performance reflector included. .40 versions come with the track adapter, the arm and the rear of the head in black.

Main specifications

| | | | |
|------------------|-------|----------------|---------------------|
| Number of heads | 1 | CRI | 90 |
| Lamp category | LED | Net lumen (lm) | 2941 |
| Power (W) | 35.3W | Mountings | Track |
| System power (W) | 35.3 | Environment | Indoor dry location |
| CCT (K) | 4000K | | |

Optical

| | |
|------------------------|-----------|
| Lighting type | Direct |
| LED type | LED array |
| Light distribution | Symmetric |
| Optical type | Flood |
| Beam angle (°) | 37 |
| Beam angle C90-270 (°) | 37 |

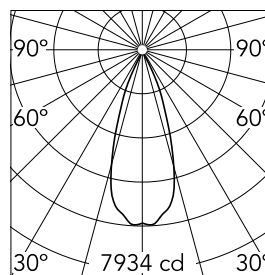

Beam Angle: 37°

| h(m) | E(lx) | D(m) |
|------|-------|------|
| 1 | 7934 | 0.66 |
| 2 | 1983 | 1.32 |
| 3 | 882 | 1.98 |
| 4 | 496 | 2.65 |
| 5 | 317 | 3.31 |

Luminous flux luminaire
2941 lm

Electrical

| | | | |
|----------------|------------|------------------|-----------------|
| Frequency (Hz) | 50/60 | Driver type | Dimmer on board |
| Voltage (V) | 220-240V | Emergency | Without |
| Current (mA) | 940 | Insulation class | II |
| Dimmable | Yes | | |
| Driver | Integrated | | |

Physical

| | | | |
|--------------|------------|--------------------|----|
| Color | White | Spot diameter (mm) | 75 |
| Orientation | Adjustable | | |
| Weight (kg) | 0.98 | | |
| Tilt (°) | 90 | | |
| Rotation (°) | 360 | | |

Note

Screening crosspiece, lenses and honeycomb directly installable on the head of the luminaire without needing any fastening accessory. Installation compatible with honeycomb + lense at the same time.

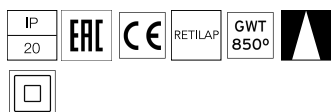
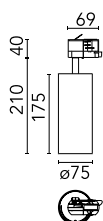
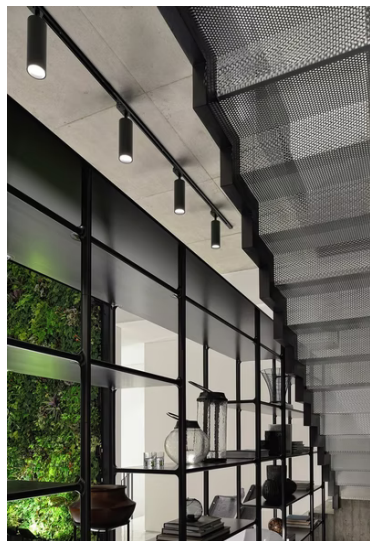

UT Pro 175 GA-69 On Board Dimmer



Honeycomb
08.9107.00



Flood Lens
08.9110.00



Elliptical Lens
08.9109.00



Snoot Shielding Cone
08.9111.00



Screening Crosspiece
08.9108.00