



The Fast Track Spot 150 Casambi integrated

New

09.9086.14 - Black

Spotlight to be installed in the The Fast Track system profile with a LED light source and glass optics: high performance spot, medium and flood lights.

Main specifications

| | | | |
|-----------------|-------|----------------|---------------------|
| Number of heads | 1 | Net lumen (lm) | 1951 |
| Lamp category | LED | Mountings | Track |
| Power (W) | 25.5W | Environment | Indoor dry location |
| CCT (K) | 4000K | | |
| CRI | 90 | | |

Optical

| | |
|------------------------|-----------|
| Lighting type | Direct |
| LED type | LED array |
| Light distribution | Symmetric |
| Optical type | Spot |
| Beam angle (°) | 16 |
| Beam angle C90-270 (°) | 16 |

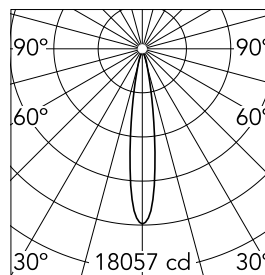

Beam Angle: 16°

h(m) E(lx) D(m)

1 18057 0.28

2 4514 0.56

3 2006 0.84

4 1129 1.12

5 722 1.40

Luminous flux luminaire
1951 lm

Electrical

| | | | |
|-------------|-----------------|------------------|-----|
| Voltage (V) | 48.00 | Insulation class | III |
| Dimmable | Yes | | |
| Driver | Remote excluded | | |
| Driver type | Dimmable | | |
| Emergency | Casambi | | |
| | Without | | |

Physical

| | | | |
|--------------|------------|--------------------|-----|
| Color | Black | Spot diameter (mm) | 57 |
| Orientation | Adjustable | Length (mm) | 240 |
| Weight (kg) | 0.83 | | |
| Tilt (°) | 90 | | |
| Rotation (°) | 360 | | |

Note

The boxes of the luminaries are manufactured only in black. The control system with the Casambi version of light fixtures is directly and individually regulated wirelessly using the application FLOS Control® by Casambi. Screening crosspiece, lenses and honeycomb directly installable on the head of the luminaire without needing any fastening accessory. Installation compatible with honeycomb + lense at the same time.

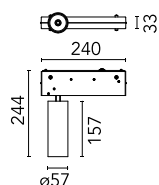
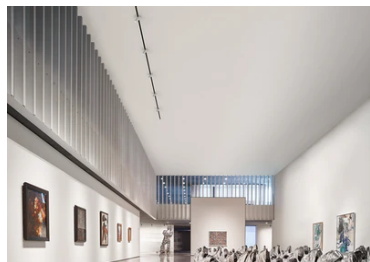

The Fast Track Spot 150 Casambi integrated



Honeycomb
08.8428.00



Screening crosspiece
08.8429.00



Snoot shielding cone
08.0526.40



Snoot shielding cone
08.0526.00

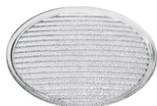

Elliptical lens
08.8431.00



Flood lens
08.8432.00



Snoot shielding cone
08.0526.BW