



The Fast Track Spot 150

09.9025.BW - White

Spotlight to be installed in the The Fast Track system profile with a LED light source and glass optics: high performance spot, medium and flood lights.

Main specifications

Number of heads	1	Net lumen (lm)	1838
Lamp category	LED	Mountings	Track
Power (W)	25.5W	Environment	Indoor dry location
CCT (K)	3000K		
CRI	90		

Optical

Lighting type	Direct
LED type	LED array
Light distribution	Symmetric
Optical type	Flood
Beam angle (°)	40
Beam angle C90-270 (°)	40

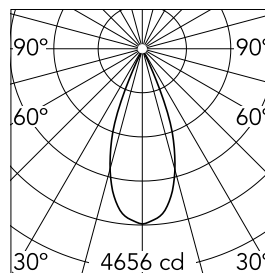

Beam Angle: 40°

	h(m)	E(lx)	D(m)
1	4656	0.73	
2	1164	1.46	
3	517	2.18	
4	291	2.91	
5	186	3.64	

Luminous flux luminaire
1838 lm

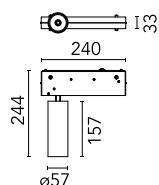
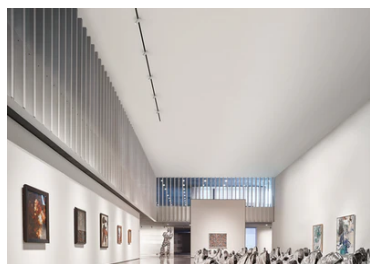

Electrical

Voltage (V)	48.00	Insulation class	III
Dimmable	Yes		
Driver	Remote excluded		
Driver type	Non Dimmable		
Emergency	Without		

Physical

Color	White	Spot diameter (mm)	57
Orientation	Adjustable	Length (mm)	240
Weight (kg)	0.83		
Tilt (°)	90		
Rotation (°)	360		

Note

The boxes of the luminaires are manufactured only in black.



The Fast Track Spot 150



Screening crosspiece
08.8429.00



Snoot shielding cone
08.0526.BW



Flood lens
08.8432.00



Honeycomb
08.8428.00



Snoot shielding cone
08.0526.00

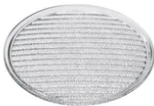

Elliptical lens
08.8431.00



Snoot shielding cone
08.0526.40