



## The Fast Track Spot 150

■ 09.9023.14 - Black

Spotlight to be installed in the The Fast Track system profile with a LED light source and glass optics: high performance spot, medium and flood lights.

### Main specifications

Number of heads	1	Net lumen (lm)	1872
Lamp category	LED	Mountings	Track
Power (W)	25.5W	Environment	Indoor dry location
CCT (K)	3000K		
CRI	90		

### Optical

Lighting type	Direct
LED type	LED array
Light distribution	Symmetric
Optical type	Spot
Beam angle (°)	16
Beam angle C90-270 (°)	16

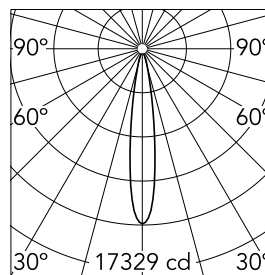

Beam Angle: 16°

h(m) E(lx) D(m)

1 17329 0.28

2 4332 0.56

3 1925 0.84

4 1083 1.12

5 693 1.40

Luminous flux luminaire  
1872 lm

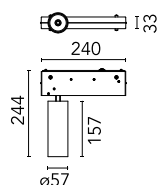
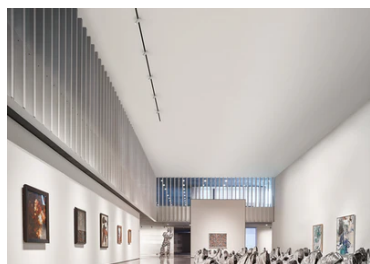

### Electrical

Voltage (V)	48.00	Insulation class	III
Dimmable	Yes		
Driver	Remote excluded		
Driver type	Non Dimmable		
Emergency	Without		

### Physical

Color	Black	Spot diameter (mm)	57
Orientation	Adjustable	Length (mm)	240
Weight (kg)	0.83		
Tilt (°)	90		
Rotation (°)	360		

### Note

The boxes of the luminaries are manufactured only in black.



The Fast Track Spot 150



Screening crosspiece  
08.8429.00



Snoot shielding cone  
08.0526.00



Honeycomb  
08.8428.00



Snoot shielding cone  
08.0526.40



Flood lens  
08.8432.00

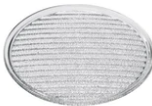

Elliptical lens  
08.8431.00



Snoot shielding cone  
08.0526.BW