



The Fast Track Spot 100

■ 09.9012.14 - Black

Spotlight to be installed in the The Fast Track system profile with a LED light source and super spot optic, very useful for great heights, medium and flood.

Main specifications

| | | | |
|-----------------|-------|----------------|---------------------|
| Number of heads | 1 | Net lumen (lm) | 693 |
| Lamp category | LED | Mountings | Track |
| Power (W) | 13W | Environment | Indoor dry location |
| CCT (K) | 3000K | | |
| CRI | 90 | | |

Optical

| | |
|------------------------|-----------|
| Lighting type | Direct |
| LED type | Power LED |
| Light distribution | Symmetric |
| Optical type | Medium |
| Beam angle (°) | 27 |
| Beam angle C90-270 (°) | 27 |

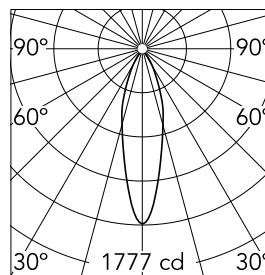

Beam Angle: 27°

| h(m) | E(lx) | D(m) |
|------|-------|------|
| 1 | 1777 | 0.48 |
| 2 | 444 | 0.95 |
| 3 | 197 | 1.43 |
| 4 | 111 | 1.91 |
| 5 | 71 | 2.38 |

Luminous flux luminaire
693 lm

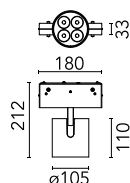
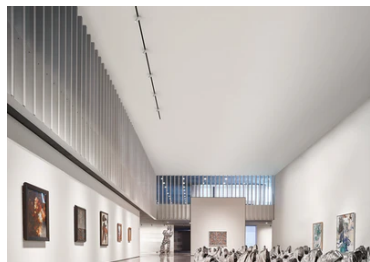

Electrical

| | | | |
|-------------|-----------------|------------------|-----|
| Voltage (V) | 48.00 | Insulation class | III |
| Dimmable | Yes | | |
| Driver | Remote excluded | | |
| Driver type | Non Dimmable | | |
| Emergency | Without | | |

Physical

| | | | |
|--------------|------------|--------------------|-----|
| Color | Black | Spot diameter (mm) | 105 |
| Orientation | Adjustable | Length (mm) | 180 |
| Weight (kg) | 1 | | |
| Tilt (°) | 90 | | |
| Rotation (°) | 360 | | |

Note

The boxes of the luminaires are manufactured only in black.

