



## The Fast Track Spot 100

09.9010.BW - White

Spotlight to be installed in the The Fast Track system profile with a LED light source and super spot optic, very useful for great heights, medium and flood.

### Main specifications

Number of heads	1	Net lumen (lm)	630
Lamp category	LED	Mountings	Track
Power (W)	13W	Environment	Indoor dry location
CCT (K)	3000K		
CRI	90		

### Optical

Lighting type	Direct
LED type	Power LED
Light distribution	Symmetric
Optical type	Super spot
Beam angle (°)	4
Beam angle C90-270 (°)	4

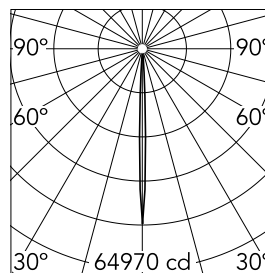

Beam Angle: 4°

h(m)	E(lx)	D(m)
1	64970	0.07
2	16243	0.14
3	7219	0.21
4	4061	0.28
5	2599	0.35

Luminous flux luminaire  
630 lm

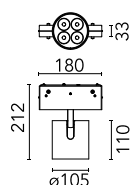
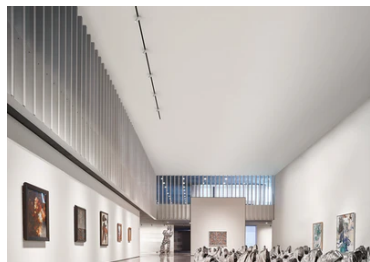

### Electrical

Voltage (V)	48.00	Insulation class	III
Dimmable	Yes		
Driver	Remote excluded		
Driver type	Non Dimmable		
Emergency	Without		

### Physical

Color	White	Spot diameter (mm)	105
Orientation	Adjustable	Length (mm)	180
Weight (kg)	1		
Tilt (°)	90		
Rotation (°)	360		

### Note

The boxes of the luminaries are manufactured only in black.

