

Spot Module On Board Dimmer

■ 03.6303.14B - Black

Accent lighting LED module to be installed in The Running Magnet System. Built-in DC/DC electronic voltage converter.



Main specifications

Number of heads	1	Net lumen (lm)	403
Lamp category	LED	Mountings	Track
Power (W)	8W	Environment	Indoor dry location
CCT (K)	2700K		
CRI	90		

Optical

Lighting type	Direct
LED type	Power LED
Light distribution	Symmetric
Optical type	Spot
Beam angle (°)	14
Beam angle C90-270 (°)	14

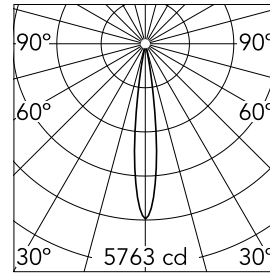

Beam Angle:	14°	
	h(m)	E(lx) D(m)
1	5763	0.24
2	1441	0.49
3	640	0.73
4	360	0.98
5	231	1.22

Luminous flux luminaire
403 lm



Electrical

Voltage (V)	24	Insulation class	III
Dimmable	Yes		
Driver	Remote excluded		
Driver type	Non Dimmable		
Emergency	Without		

Physical

Color	Black	Spot diameter (mm)	34
Orientation	Adjustable	Length (mm)	34
Weight (kg)	0.19		
Tilt (°)	90		
Rotation (°)	360		

Note

Maximum 21 spots for a single driver. For wireless lighting control, choose integrated Casambi versions.

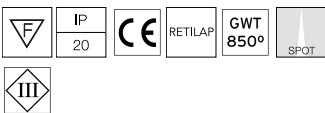
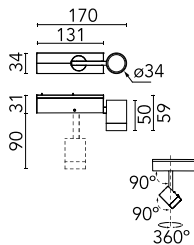

Spot Module On Board Dimmer



Screening external ring for Running
Magnet spot module
08.8427.14



Elliptical Lens
08.8759.00



Frosted Flood lens
08.8761.00



Frosted Medium lens
08.8760.00