

## Spot Module On Board Dimmer

■ 03.6302.14B - Black

Accent lighting LED module to be installed in The Running Magnet System. Built-in DC/DC electronic voltage converter.



### Main specifications

Number of heads	1	Net lumen (lm)	418
Lamp category	LED	Mountings	Track
Power (W)	8W	Environment	Indoor dry location
CCT (K)	3000K		
CRI	90		

### Optical

Lighting type	Direct
LED type	Power LED
Light distribution	Symmetric
Optical type	Spot
Beam angle (°)	14
Beam angle C90-270 (°)	14

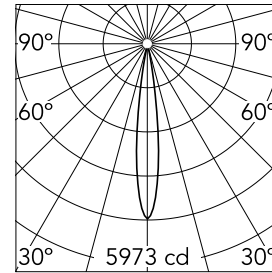

Beam Angle:	14°	
	h(m)	E(lx) D(m)
1	5973	0.24
2	1493	0.49
3	664	0.73
4	373	0.98
5	239	1.22

Luminous flux luminaire  
418 lm



### Electrical

Voltage (V)	24	Insulation class	III
Dimmable	Yes		
Driver	Remote excluded		
Driver type	Non Dimmable		
Emergency	Without		

### Physical

Color	Black	Spot diameter (mm)	34
Orientation	Adjustable	Length (mm)	34
Weight (kg)	0.19		
Tilt (°)	90		
Rotation (°)	360		

### Note

Maximum 21 spots for a single driver. For wireless lighting control, choose integrated Casambi versions.

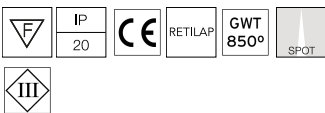
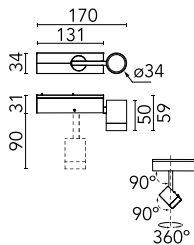

## Spot Module On Board Dimmer



---

Frosted Flood lens  
08.8761.00



---

Frosted Medium lens  
08.8760.00



---

Screening external ring for Running  
Magnet spot module  
08.8427.14



---

Elliptical Lens  
08.8759.00