

## Spot Module Dali Version

■ 03.6303.14BDA - Black

Accent lighting LED module to be installed in The Running Magnet System. Built-in DC/DC electronic voltage converter.



### Main specifications

<b>Number of heads</b>	1	<b>Net lumen (lm)</b>	403
<b>Lamp category</b>	LED	<b>Mountings</b>	Track
<b>Power (W)</b>	8W	<b>Environment</b>	Indoor dry location
<b>CCT (K)</b>	2700K		
<b>CRI</b>	90		

### Optical

<b>Lighting type</b>	Direct
<b>LED type</b>	Power LED
<b>Light distribution</b>	Symmetric
<b>Optical type</b>	Spot
<b>Beam angle (°)</b>	14
<b>Beam angle C90-270 (°)</b>	14

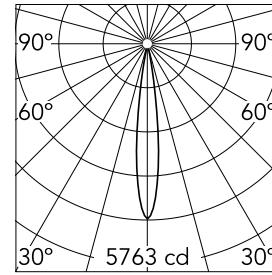

<b>Beam Angle:</b>	14°	
<b>h(m)</b>	<b>E(lx)</b>	<b>D(m)</b>
1	5763	0.24
2	1441	0.49
3	640	0.73
4	360	0.98
5	231	1.22

Luminous flux luminaire  
403 lm



### Electrical

<b>Voltage (V)</b>	24	<b>Insulation class</b>	III
<b>Dimmable</b>	Yes		
<b>Driver</b>	Remote excluded		
<b>Driver type</b>	Dimmable DALI		
<b>Emergency</b>	Without		

### Physical

<b>Color</b>	Black	<b>Spot diameter (mm)</b>	34
<b>Orientation</b>	Adjustable	<b>Length (mm)</b>	34
<b>Weight (kg)</b>	0.19		
<b>Tilt (°)</b>	90		
<b>Rotation (°)</b>	360		

### Note

Maximum 14 spots for a single driver. Maximum 64 spots for a single DALI controller. For wireless lighting control, choose integrated Casambi versions.

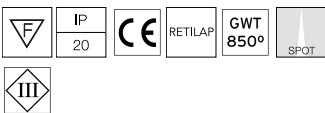
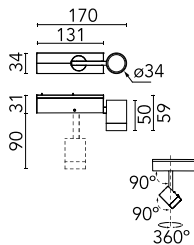

## Spot Module Dali Version



---

Frosted Flood lens  
08.8761.00



---

Elliptical Lens  
08.8759.00



---

Frosted Medium lens  
08.8760.00



---

Screening external ring for Running  
Magnet spot module  
08.8427.14