



Solid Pure Track Dali Version

09.2879.30.DA - White

Spotlight to be installed on 3-phase track with LED light source. 220-240V, 50-60Hz power supply included.

Main specifications

| | | | |
|-----------------|-------|----------------|---------------------|
| Number of heads | 1 | Net lumen (lm) | 3239 |
| Lamp category | LED | Mountings | Track |
| Power (W) | 30W | Environment | Indoor dry location |
| CCT (K) | 4000K | | |
| CRI | 80 | | |

Optical

| | |
|------------------------|-----------|
| Lighting type | Direct |
| LED type | LED array |
| Light distribution | Symmetric |
| Optical type | Spot |
| Beam angle (°) | 14 |
| Beam angle C90-270 (°) | 14 |

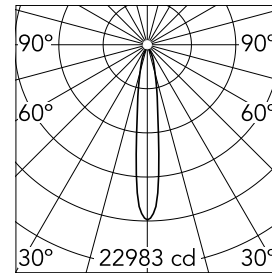

| | |
|-------------|-----------------|
| Beam Angle: | 14° |
| | h(m) E(lx) D(m) |
| | 1 22983 0.25 |
| | 2 5746 0.51 |
| | 3 2554 0.76 |
| | 4 1436 1.01 |
| | 5 919 1.27 |

Luminous flux luminaire
3239 lm

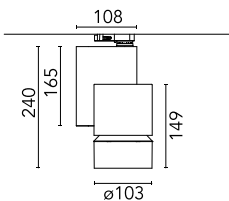

Electrical

| | | | |
|----------------|---------------|------------------|---|
| Frequency (Hz) | 50/60 | Insulation class | I |
| Dimmable | Yes | | |
| Driver | Integrated | | |
| Driver type | Dimmable DALI | | |
| | 1 | | |
| Emergency | Without | | |

Physical

| | |
|--------------|------------|
| Color | White |
| Orientation | Adjustable |
| Weight (kg) | 1.70 |
| Rotation (°) | 360 |

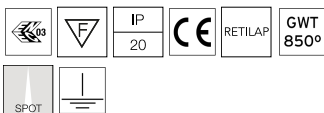

Solid Pure Track Dali Version



Holding ring
08.8768.14



Honeycomb anti-glare screen
08.8763.14

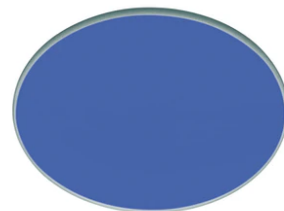

Blue filter
08.8766.64.OD

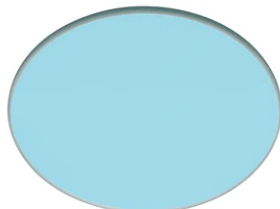

Sky blue filter
08.8766.65.OD

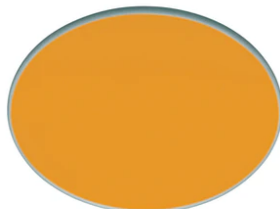

Amber filter
08.8766.66.OD

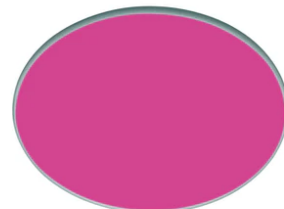

Red filter
08.8766.67.OD