

## Pure 1 Spot Pro Ceiling

■ 09.2477.02A - Grey

Spotlight to be installed on ceiling/wall with LED light source. 220/240V, 50/60Hz power supply integrated.



### Main specifications

<b>Number of heads</b>	1	<b>Net lumen (lm)</b>	664
<b>Lamp category</b>	LED	<b>Mountings</b>	Ceiling surface
<b>Power (W)</b>	15.7W	<b>Environment</b>	Indoor dry location
<b>CCT (K)</b>	2700K		
<b>CRI</b>	80		

### Optical

<b>Lighting type</b>	Direct
<b>LED type</b>	Power LED
<b>Light distribution</b>	Symmetric
<b>Optical type</b>	Flood
<b>Beam angle (°)</b>	30
<b>Beam angle C90-270 (°)</b>	30

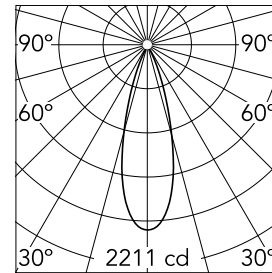

Beam Angle: 30°

h(m)	E(lx)	D(m)
1	2211	0.54
2	553	1.08
3	246	1.62
4	138	2.16
5	88	2.70

Luminous flux luminaire  
664 lm



### Electrical

<b>Frequency (Hz)</b>	50/60	<b>Insulation class</b>	I
<b>Dimmable</b>	No		
<b>Driver</b>	Integrated		
<b>Driver type</b>	Non Dimmable		
<b>Emergency</b>	Without		

### Physical

<b>Color</b>	Grey
<b>Orientation</b>	Adjustable
<b>Weight (kg)</b>	1.40
<b>Tilt (°)</b>	90
<b>Rotation (°)</b>	180

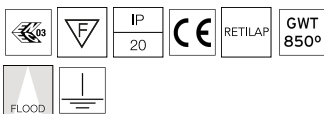
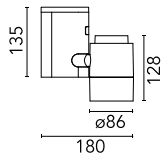

## Pure 1 Spot Pro Ceiling

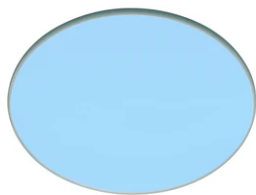

---

Daylight filter  
08.8160.DL

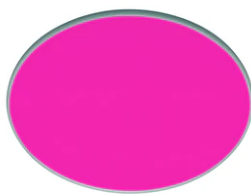

---

Red filter  
08.8160.67.OD



---

U.V. filter  
08.8160.98.OD



---

Flood lens  
08.8175.68



---

I.R. filter  
08.8160.68



---

Sky blue filter  
08.8160.65.OD

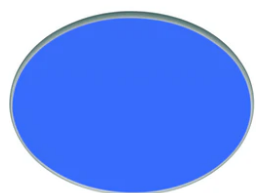

---

Blue filter  
08.8160.64.OD



---

Hot Light  
08.8160.69



---

Neodimium  
08.8160.ND



---

Elliptical lens  
08.8163.68

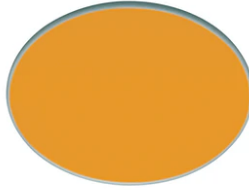

---

Amber filter  
08.8160.66.OD

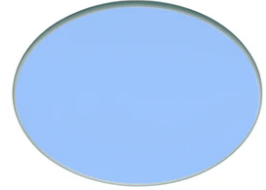

---

Cold light filter  
08.8160.CL



---

Honeycomb  
08.8186.14