

Kap Ø80 Fixed Optic Medium

■ 03.4180.BU - Blue

Recessed luminaire with LED light source. Power supply not included. Diffusing lens included.

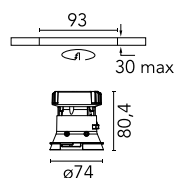
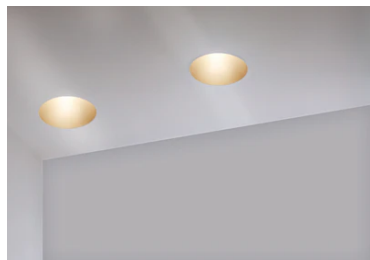

Main specifications

Number of heads	1	Net lumen (lm)	495
Lamp category	LED	Mountings	Ceiling recessed
Power (W)	9.2W	Environment	Indoor
CCT (K)	3000K		
CRI	90		

Optical

Lighting type	Direct
LED type	LED array
Light distribution	Symmetric
Optical type	Medium
Beam angle (°)	26
Beam angle C90-270 (°)	26
Efficiency (lm/W)	53

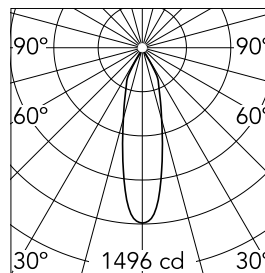

Beam Angle: 26°

h(m)	E(lx)	D(m)
1	1496	0.47
2	374	0.93
3	166	1.40
4	93	1.87
5	60	2.34

Luminous flux luminaire
495 lm (EXTREME CUT OFF)

Electrical

Voltage (V)	17.80	Emergency	Without
Current (mA)	500	Insulation class	III
Dimmable	Yes		
Driver	Remote		
Driver type	Electronic, Electronic dimmable, Electronic dimmable 1-10V, Electronic dimmable DALI		

Physical

Color	Blue
Orientation	Fixed
Recessed depth (mm)	91
Weight (kg)	0.24
Spot diameter (mm)	74

Note

Diffusing lens included.

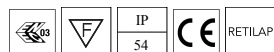

Kap Ø80 Fixed Optic Medium



Installation frame No Trim
08.9102.00



Non dimmable continuous current power supply of 220/240V – 50/60Hz with power current selected through adjustable with switch 200mA – 8,5W / 250mA – 11W / 300mA – 13W / 350mA – 15W / 400mA – 17,5W / 450mA 19,5W / 500mA – 22W.
60.9160



Continuous current power supply of 13-20W, 110/240V – 50/60Hz with power current selected through adjustable 300 mA – 15W / 350 mA – 18W / 400/450/500/550/600/ 650/700/750/800/850/900 mA – 15W. switch. 0/1-10V or push dimming
60.9188



Continuous current power supply of 10-20W, 110/240V – 50/60Hz with power current selected through adjustable 250 mA – 10W / 350 mA – 15W / 400 mA – 17W / 450 mA – 19W / 500/550/600/700 mA – 20W, Dali 1 switch.
60.8847



Continuous current power supply of 12-20W, 110/240V – 50/60Hz with power current selected through adjustable 350mA – 17W / 400mA – 19W / 450 / 550 / 600 / 700mA – 20W regulable Dali 1 y Dali 2
60.9222



Continuous current power supply, Mains dimming , 220/240V – 50/60Hz, 10W – 500mA.
60.9411



Continuous current power supply,
dimmable Casambi, 220/240V –
50/60Hz, 35W – 650mA / 36W – 700 mA.
60.9207