

Easy Kap Ø 80 Adjustable

■ 03.4160.CU - Copper

Recessed 12V lamp luminaire. Remote transformer not included. Installation frame not necessary.



Main specifications

Number of heads	1
Lamp category	LED retrofit
Mountings	Ceiling recessed
Environment	Indoor dry location

Optical

Lighting type	Direct
Lamp type	QR-CBC 51
Light distribution	Symmetric

Electrical

Frequency (Hz)	50/60	Emergency	Without
Lamp holder	GX5.3	Insulation class	III
Dimmable	No		
Driver	Remote excluded		
Driver type	Electronic 12V		

Physical

Color	Copper	Tilt (°)	20
Orientation	Adjustable	Rotation (°)	360
Trim	yes	Spot diameter (mm)	80
Recessed depth (mm)	130		
Weight (kg)	0.12		

Note

Not suitable for lens accessories.

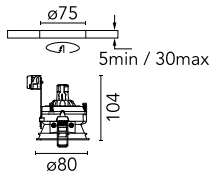

Easy Kap Ø 80 Adjustable



12V electronic transformer. 220/240V,
50/60Hz. Adjustable by means of
"leading and trailing edge"
60.9424

12V Electronic Transformer 20-70W for
LED Bulbs and Halogen Lamps
60.9398