

Continuous current power supply. Switch by trailing and leading edge dimming, mains dimming or push dimming. 32W

Continuous current power supply of 32W, 230/240V – 50/60Hz with power current selected through adjustable 350mA (17W) / 500mA (24W) / 700mA (32W) switch by trailing and leading edge dimming, mains dimming or push dimming.

Continuous current power supply of 32W, 230/240V – 50/60Hz with power current selected through adjustable 350mA (17W) / 500mA (24W) / 700mA (32W) switch by trailing and leading edge dimming, mains dimming or push dimming.



Electrical

Emergency

Without

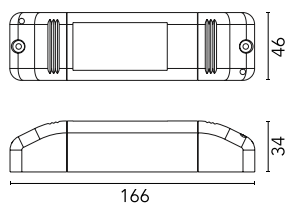

Certification / Marking

