



## Camera 90 GA-69 Potenciometer

New

09.8217.WA.PC - Textured White

Spotlight to be installed on 3-phase track with LED light source. 220- 240V, 50-60Hz power supply integrated.

### Main specifications

Number of heads	1	Net lumen (lm)	2304
Lamp category	LED	Mountings	Track GA
Power (W)	32W	Environment	Indoor dry location
CCT (K)	3500K		
CRI	97		

### Optical

Lighting type	Direct
LED type	LED array
Light distribution	Symmetric
Optical type	Medium
Beam angle (°)	25
Beam angle C90-270 (°)	25

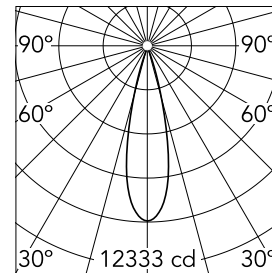

Beam Angle: 25°

h(m)	E(lx)	D(m)
1	12333	0.45
2	3083	0.90
3	1370	1.35
4	771	1.80
5	493	2.25

Luminous flux luminaire  
2304 lm

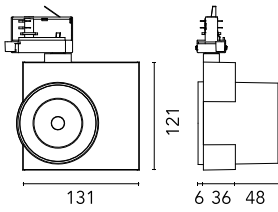

### Electrical

Frequency (Hz)	50/60	Insulation class	I
Dimmable	Yes		
Driver	Integrated		
Driver type	Dimmer on board		
Emergency	Without		

### Physical

Color	Textured White	Spot diameter (mm)	90
Orientation	Adjustable	Length (mm)	131
Weight (kg)	0.75		
Tilt (°)	90		
Rotation (°)	360		



## Camera 90 GA-69 Potenciómeter



---

Honeycomb  
08.0178.14