



Camera 90 GA-69 Non Dimmable

09.8216.DR - Anthracite

Spotlight to be installed on 3-phase track with LED light source. 220- 240V, 50-60Hz power supply integrated.

Spotlight to be installed on 3-phase track with LED light source. 220- 240V, 50-60Hz power supply integrated.

Main specifications

Number of heads	1	Mountings	Track GA
Lamp category	LED	Environment	Indoor
Power (W)	32W		
CCT (K)	3500K		
CRI	97		

Optical

Lighting type	Direct
LED type	LED array
Light distribution	Symmetric
Optical type	Spot
Beam angle (°)	13
Beam angle C90-270 (°)	13

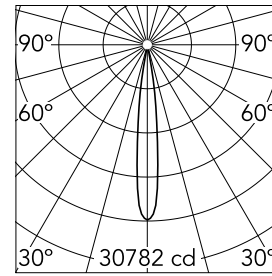

Beam Angle: 13°

h(m) E(lx) D(m)

1 30782 0.23

2 7695 0.45

3 3420 0.68

4 1924 0.91

5 1231 1.13

Luminous flux luminaire
2366 lm

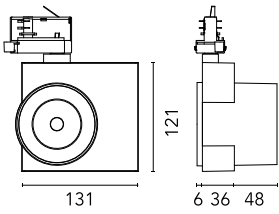

Electrical

Frequency (Hz)	50/60	Insulation class	I
Dimmable	No		
Driver	Integrated		
Driver type	Electronic		
Emergency	Without		

Physical

Color	Anthracite	Spot diameter (mm)	90
Orientation	Adjustable	Length (mm)	131
Weight (kg)	0.75		
Tilt (°)	90		
Rotation (°)	360		

Certification / Marking

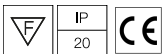

Note

Preliminary photometry.

Camera 90 GA-69 Non Dimmable



Honeycomb
08.0177.14