

## Camera 90 GA-69 Non Dimmable

New

09.8213.WA - Textured White

Spotlight to be installed on 3-phase track with LED light source. 220- 240V, 50-60Hz power supply integrated.

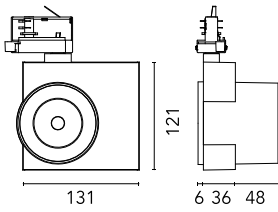

### Main specifications

Number of heads	1	Net lumen (lm)	2066
Lamp category	LED	Mountings	Track GA
Power (W)	32W	Environment	Indoor dry location
CCT (K)	3000K		
CRI	97		

### Optical

Lighting type	Direct
LED type	LED array
Light distribution	Symmetric
Optical type	Flood
Beam angle (°)	43
Beam angle C90-270 (°)	43

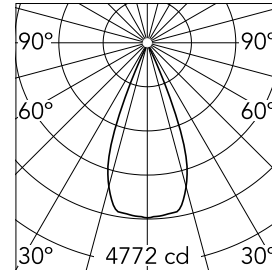

Beam Angle: 43°

h(m)	E(lx)	D(m)
1	4772	0.78
2	1193	1.56
3	530	2.34
4	298	3.12
5	191	3.90

Luminous flux luminaire  
2066 lm

### Electrical

Frequency (Hz)	50/60	Insulation class	I
Dimmable	No		
Driver	Integrated		
Driver type	Non Dimmable		
Emergency	Without		

### Physical

Color	Textured White	Spot diameter (mm)	90
Orientation	Adjustable	Length (mm)	131
Weight (kg)	0.75		
Tilt (°)	90		
Rotation (°)	360		

## Camera 90 GA-69 Non Dimmable



---

Honeycomb  
08.0178.14