



Camera 90 GA-69 Non Dimmable

09.8211.WA - Textured White

Spotlight to be installed on 3-phase track with LED light source. 220- 240V, 50-60Hz power supply integrated.

Spotlight to be installed on 3-phase track with LED light source. 220- 240V, 50-60Hz power supply integrated.

Main specifications

Number of heads	1	Net lumen (lm)	2298
Lamp category	LED	Mountings	Track GA
Power (W)	32W	Environment	Indoor
CCT (K)	3000K		
CRI	97		

Optical

Lighting type	Direct
LED type	LED array
Light distribution	Symmetric
Optical type	Spot
Beam angle (°)	13
Beam angle C90-270 (°)	13

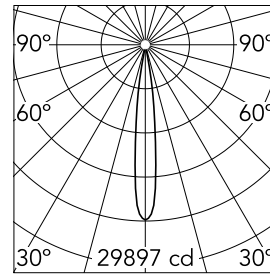

Beam Angle: 13°

h(m) E(lx) D(m)

1 29897 0.23

2 7474 0.45

3 3322 0.68

4 1869 0.91

5 1196 1.13

Luminous flux luminaire
2298 lm

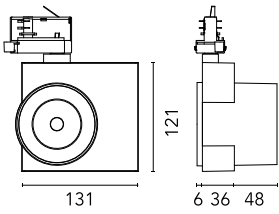

Electrical

Frequency (Hz)	50/60	Insulation class	I
Dimmable	No		
Driver	Integrated		
Driver type	Electronic		
Emergency	Without		

Physical

Color	Textured White	Spot diameter (mm)	90
Orientation	Adjustable	Length (mm)	131
Weight (kg)	0.75		
Tilt (°)	90		
Rotation (°)	360		

Certification / Marking

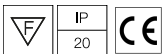

Note

Preliminary photometry.

Camera 90 GA-69 Non Dimmable



Honeycomb
08.0177.14