



## Camera 90 GA-69 Casambi integrated

■ 09.8211.DR.CB - Anthracite

Spotlight to be installed on 3-phase track with LED light source. 220- 240V, 50-60Hz power supply integrated.

Spotlight to be installed on 3-phase track with LED light source. 220- 240V, 50-60Hz power supply integrated.

### Main specifications

<b>Number of heads</b>	1	<b>Net lumen (lm)</b>	2298
<b>Lamp category</b>	LED	<b>Mountings</b>	Track GA
<b>Power (W)</b>	32W	<b>Environment</b>	Indoor
<b>CCT (K)</b>	3000K		
<b>CRI</b>	97		

### Optical

<b>Lighting type</b>	Direct
<b>LED type</b>	LED array
<b>Light distribution</b>	Symmetric
<b>Optical type</b>	Spot
<b>Beam angle (°)</b>	13
<b>Beam angle C90-270 (°)</b>	13

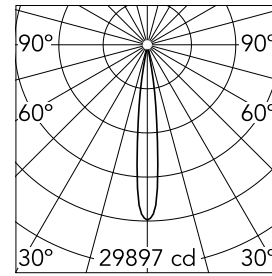

Beam Angle: 13°

h(m) E(lx) D(m)

1 29897 0.23

2 7474 0.45

3 3322 0.68

4 1869 0.91

5 1196 1.13

Luminous flux luminaire  
2298 lm

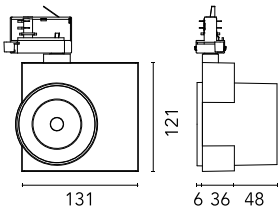

### Electrical

<b>Frequency (Hz)</b>	50/60	<b>Insulation class</b>	I
<b>Dimmable</b>	Yes		
<b>Driver</b>	Integrated		
<b>Driver type</b>	Electronic dimmable CASAMBI		

### Emergency

Without

### Certification / Marking

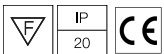

### Physical

<b>Color</b>	Anthracite	<b>Spot diameter (mm)</b>	90
<b>Orientation</b>	Adjustable	<b>Length (mm)</b>	131
<b>Weight (kg)</b>	0.75		
<b>Tilt (°)</b>	90		
<b>Rotation (°)</b>	360		

### Note

The control system with the Casambi version of light fixtures is directly and individually regulated wirelessly using the application FLOS Control® by Casambi.  
Preliminary photometry.

## Camera 90 GA-69 Casambi integrated



---

Honeycomb  
08.0177.14