

Atom 90

■ 09.3833.18 - Deep Brown



LED accent lighting module to be installed in the Zero Track system. Incorporated DC/DC electronic converter. Module regulated via 1–10-V DALI or Casambi driver in broadcast mode. Dimmer not included. To individually control the lights, select integrated Casambi versions.

LED accent lighting module to be installed in the Zero Track system. Incorporated DC/DC electronic converter. Module regulated via 1–10-V DALI or Casambi driver in broadcast mode. Dimmer not included. To individually control the lights, select integrated Casambi versions.

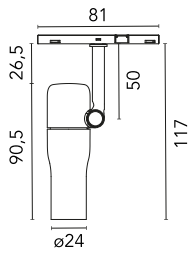

Main specifications

Number of heads	1	Net lumen (lm)	217
Lamp category	LED	Mountings	Track
Power (W)	5.5W	Environment	Indoor
CCT (K)	2700K		
CRI	90		

Optical

Lighting type	Direct
LED type	Power LED
Light distribution	Symmetric
Optical type	Medium
Beam angle (°)	26
Beam angle C90-270 (°)	26

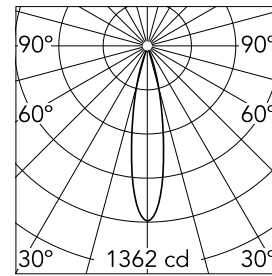

Beam Angle:	21°		
	h(m)	E(lx)	D(m)
1	1362	0.37	
2	341	0.73	
3	151	1.10	
4	85	1.47	
5	54	1.84	

Luminous flux luminaire
217 lm

Electrical

Voltage (V)	24.00	Insulation class	III
Dimmable	Yes		
Driver	Remote		
Driver type	Electronic, Electronic dimmable CASAMBI, Electronic dimmable 1- 10V, Electronic dimmable DALI		
Emergency	Without		

Physical

Color	Deep Brown	Spot diameter (mm)	23
Orientation	Adjustable	Length (mm)	23
Weight (kg)	0.10		
Tilt (°)	90		
Rotation (°)	360		

Note

Accessories included (honeycomb and screening crosspiece).

Certification / Marking

