

Atom 120 Casambi integrated

New

09.3942.CZA - Bronze

Accent lighting LED module. Incorporated DC/DC electronic converter. Casambi via Flos Control App to individually control the lights.

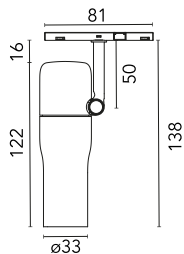

Main specifications

Number of heads	1	Net lumen (lm)	373
Lamp category	LED	Mountings	Track
Power (W)	8W	Environment	Indoor dry location
CCT (K)	3000K		
CRI	90		

Optical

Lighting type	Direct
LED type	Power LED
Light distribution	Symmetric
Optical type	Medium
Beam angle (°)	20
Beam angle C90-270 (°)	20

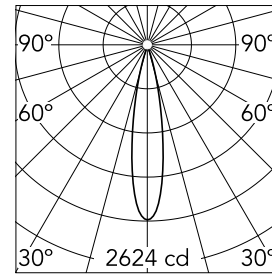

Beam Angle:	20°		
	h(m)	E(lx)	D(m)
1	2624	0.35	
2	656	0.70	
3	292	1.06	
4	164	1.41	
5	105	1.76	

Luminous flux luminaire
373 lm

Electrical

Voltage (V)	24	Insulation class	III
Dimmable	Yes		
Driver	Remote excluded		
Driver type	Dimmable Casambi		
Emergency	Without		

Physical

Color	Bronze	Spot diameter (mm)	33
Orientation	Adjustable	Length (mm)	33
Weight (kg)	0.22		
Tilt (°)	90		
Rotation (°)	360		

Note

Accessories included (honeycomb and screening crosspiece). The control system with the Casambi version of light fixtures is directly and individually regulated wirelessly using the application FLOS Control® powered by Casambi. Other types of regulation are broadcast (all lights are regulated at the same time)

