

Anthony Spot Track Dimmable 1-10V

03.8027.40.1V - White

Accent lighting LED module to be installed in The Tracking Magnet System. To obtain flood optics (35°) order Anthony Spot Medium + flood lens.



Main specifications

Number of heads	1	Net lumen (lm)	1425
Lamp category	LED	Mountings	Track
Power (W)	16.5W	Environment	Indoor dry location
CCT (K)	3000K		
CRI	90		

Optical

Lighting type	Direct
LED type	LED array
Light distribution	Symmetric
Optical type	Spot
Beam angle (°)	15
Beam angle C90-270 (°)	15

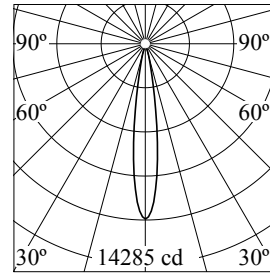

Beam Angle:	15°	
	h(m)	E(lx) D(m)
	1	14285 0.27
	2	3571 0.54
	3	1587 0.81
	4	893 1.07
	5	571 1.34

Luminous flux luminaire
1425 lm

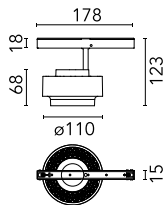

Electrical

Voltage (V)	48.00	Insulation class	III
Dimmable	Yes		
Driver	Remote excluded		
Driver type	Dimmable 1-10V		
Emergency	Without		

Physical

Color	White	Spot diameter (mm)	110
Orientation	Adjustable		
Weight (kg)	0.43		
Tilt (°)	90		
Rotation (°)	360		

Note

Only compatible with 1-10V profile version. For wireless lighting control, choose integrated Casambi versions.

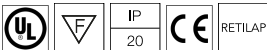

Anthony Spot Track Dimmable 1-10V



Honeycomb
08.8419.14A



Flood lens
08.0050.00



Elliptical lens
08.8418.68A