

Anthony Spot Track Casambi integrated

■ 03.8025.14.CB - Black

Accent lighting LED module to be installed in The Tracking Magnet System. To obtain flood optics (35°) order Anthony Spot Medium + flood lens.



Main specifications

Number of heads	1	Net lumen (lm)	1241
Lamp category	LED	Mountings	Track
Power (W)	16.5W	Environment	Indoor
CCT (K)	2700K		
CRI	90		

Optical

Lighting type	Direct
LED type	LED array
Light distribution	Symmetric
Optical type	Spot
Beam angle (°)	15
Beam angle C90-270 (°)	15

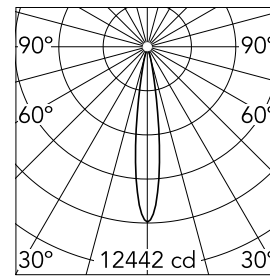

Beam Angle:	15°		
	h(m)	E(lx)	D(m)
1	12442	0.27	
2	3110	0.54	
3	1382	0.81	
4	778	1.07	
5	498	1.34	

Luminous flux luminaire
1241 lm

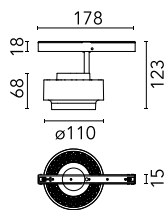
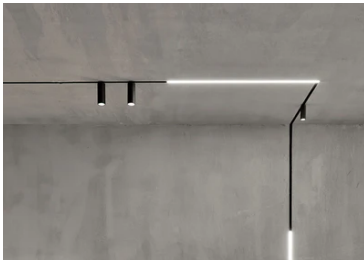

Electrical

Voltage (V)	48.00	Insulation class	III
Dimmable	Yes		
Driver	Remote		
Driver type	Electronic, Dimmer on board		
Emergency	Without		

Physical

Color	Black	Spot diameter (mm)	110
Orientation	Adjustable		
Weight (kg)	0.43		
Tilt (°)	90		
Rotation (°)	360		

Note

The control system with the Casambi version of light fixtures is directly and individually regulated wirelessly using the application FLOS Control® by Casambi.

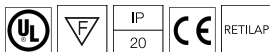

Anthony Spot Track Casambi integrated



Honeycomb
08.8419.14A



Flood lens
08.0050.00



Elliptical lens
08.8418.68A